

Installation Instructions

安裝說明書

FRONT FORK, 25MM SHORTER

前避震叉 短25MM

#Q0222

Application 適用車型

Honda Civic '96-01

Does not fit USDM EJ6/EJ7/EJ8 models
不適用美規 EJ6/EJ7/EJ8 車型

Components 內含配件

- ① Fork-RH 避震叉-右.....1pcs
- ② Fork-LH 避震叉-左.....1pcs
- ③ Bolt 螺絲 (M12x1.25x120).....2pcs
- ④ Nut 螺帽 (M12x1.25-19x13.5).....2pcs

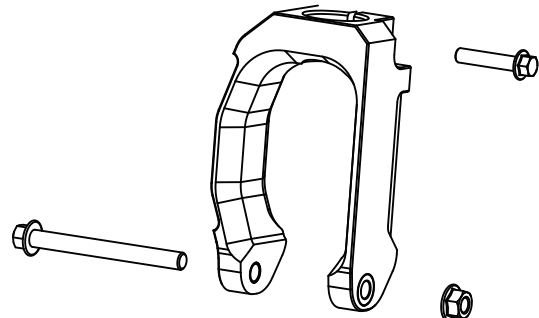

Caution 注意事項

- Installation is recommended to be performed by licensed mechanics with necessary tools to ensure proper installation and safety, or damage to the product or vehicle may occur.
- Note the routing and position of wires and cables before installation. Please refer to factory manual.
- Tighten bolts and nuts firmly using handtools, or with specified torque if mentioned.
- 安裝需由合格的專業技師及工具執行以確保安裝正確及安全。否則可能對產品或車輛造成傷害。
- 安裝前請記下線路安裝路徑及位置，或請參考原廠手冊。
- 請使用手動工具確實鎖緊螺帽及螺絲，或依照說明中標註的扭力上鎖。

Instructions 安裝說明

1. Remove factory front forks from lower control arms and shock absorbers on both sides. (See figure 1)
將原廠避震叉從控制臂及避震器上卸下。(參考圖表一)
2. Install Forks to lower control arms using supplied bolts and nuts. Please note the curved side should be installed toward front.
使用配件螺絲及螺帽將避震叉安裝於前下控制臂，安裝時請注意彎曲的一邊應朝前方
3. Install the forks to shock absorbers using factory bolts.
使用拆下的原廠螺絲將避震叉安裝於前避震器。

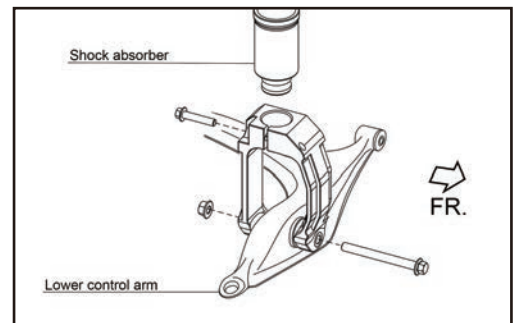

Illustration of installed state
安裝完成示意圖

Note 提示

※ The fork is designed to set front end 25mm lower, please adjust coilovers to appropriate ride height to avoid wheels from rubbing wheel arches and suspension components.

此避震叉為特殊改裝降低使用，請妥善設定懸吊高度以避免干涉問題。

※ Inspect lower control arm bushings connect to the forks, replace them if worn or cracked.

請檢查前下控制臂連接避震叉的鐵套，如有龜裂及變形應一併更換。